



Point Zenith Public Library

Primary Project Identification

Introduction
Project Type: New Construction - Public Library
Project Size: ~30,000 Square Feet
Project Location: Canal District, Duluth, MN
Climate Zone: 6A - Cold Climate
Occupancy Type: A-3 (Assembly)
Construction Type: Type IIB, Fully Sprinklered (NFPA-13)

Point Zenith Public Library is rooted in the landscape and culture of Duluth, MN. This two-story facility is designed to reflect the values of sustainability, community engagement, lifelong learning, and inclusive design. Using my design concept of Nature & Knowledge, it blends sustainability with lifelong learning, aiming to create a functional and inviting library that stands for both discovery and connection to one's environment. Taking inspiration from Lake Superior, Duluth's industrial past, and the surrounding forests, this library incorporates natural materials, daylight harvesting, and biophilic design strategies to help foster a sense of connection between people, place, and knowledge. Spatial zoning is designed to be intuitive and accessible for all!

Logo Breakdown

Sun: plants and people both need the sun to thrive. This sun also helps bring home the theme of natural light!
Outline: The outline of the logo is in the shape of a book!
Hill: The hill(s) represent Duluth as a city on a hill.
Water: The water represents both Lake Superior and the many other lakes that are in Minnesota.

Pine Tree: The pine tree stands tall as a symbol of nature in the Midwest.
Lighthouse: I wanted to use a landmark other than the Aerial Lift Bridge for this logo. I also feel as though the lighthouse helps represent the library as a "beacon of learning."

Perspective Views - Upstairs Stack Area & Garden



Research & Ideation

Biophilic Design and Natural Light Plants help improve air quality, reduce stress, and enhance visual comfort . Plants in interior spaces also help foster a connection to nature . Natural light helps reduce energy usage, boosts energy levels in people , and helps spaces truly shine. <i>Point Zenith Public Library uses greenery to soften its spaces, especially in the garden, wellness, and children's areas. The garden is hosted in a glass enclosure that allows natural light to flood the space. Glass windows and glass walls help natural light flood other spaces as well.</i>	Color & Materials Autism-friendly environments encourage vibrant, highly saturated colors and adjustable lighting . Visual elements should be influenced by the branding and the identity of the space. <i>Point Zenith Public Library has a color palette, furniture selections, and logo that all work together to form a visual identity; whether you're interacting with us online or in-person. Furthermore, Bold accent colors will be used in the sensory, children, and teen spaces.</i>	Wellness, Mental Health, & Inclusivity Libraries should strive to become social hubs that also offer mental health/wellness support. They should also prioritize accessibility, flexibility, and simplicity for all users. <i>Point Zenith Public Library has a sensory room and multiple quiet study areas. The garden also acts as a refuge for those who need a moment to breathe. ADA-compliant pathways, accessible restrooms, and inclusive seating are all provided for those who may struggle to get around.</i>
Wayfinding & Layout Successful libraries have clear spatial zoning, good lighting , and effective acoustic planning . Design is about problem-solving , not just visual style. Line, shape, space, contrast, and other elements of design should be used strategically. <i>Point Zenith Public Library uses lighting, finishes, and proper signage for intuitive navigation of each space. Elements of design are used in signage and layout to guide those who use the space.</i>	Youth & Teen Spaces Teen-centered Public Libraries give teens ownership of their spaces. Human-centered design means empathizing with your users (especially the youth). Work with them, help them learn, and make them feel like they have independence. <i>Point Zenith Public Library includes a teen space with interactive tech and comfortable seating. The teen, child, and sensory spaces will continue to be shaped by user needs and feedback.</i>	Putting the User First Library design should strive to connect communities . Libraries are no longer just book storage—they're becoming learning ecosystems . Libraries became hybrid during COVID: ebooks, curbside pickup, online learning. People want and deserve more. The most common library complaints? Noise levels and lack of seating. <i>Point Zenith Public Library offers book pick-up at the reception desk, along with digital lending at any of the kiosks. Hands-on areas like the makerspace and digital resource lab help the library feel like a space for learning. Acoustic zoning helps with noise, and abundant seating in public spaces helps with seating options for all ages.</i>

Floor Plan - Levels 1 & 2

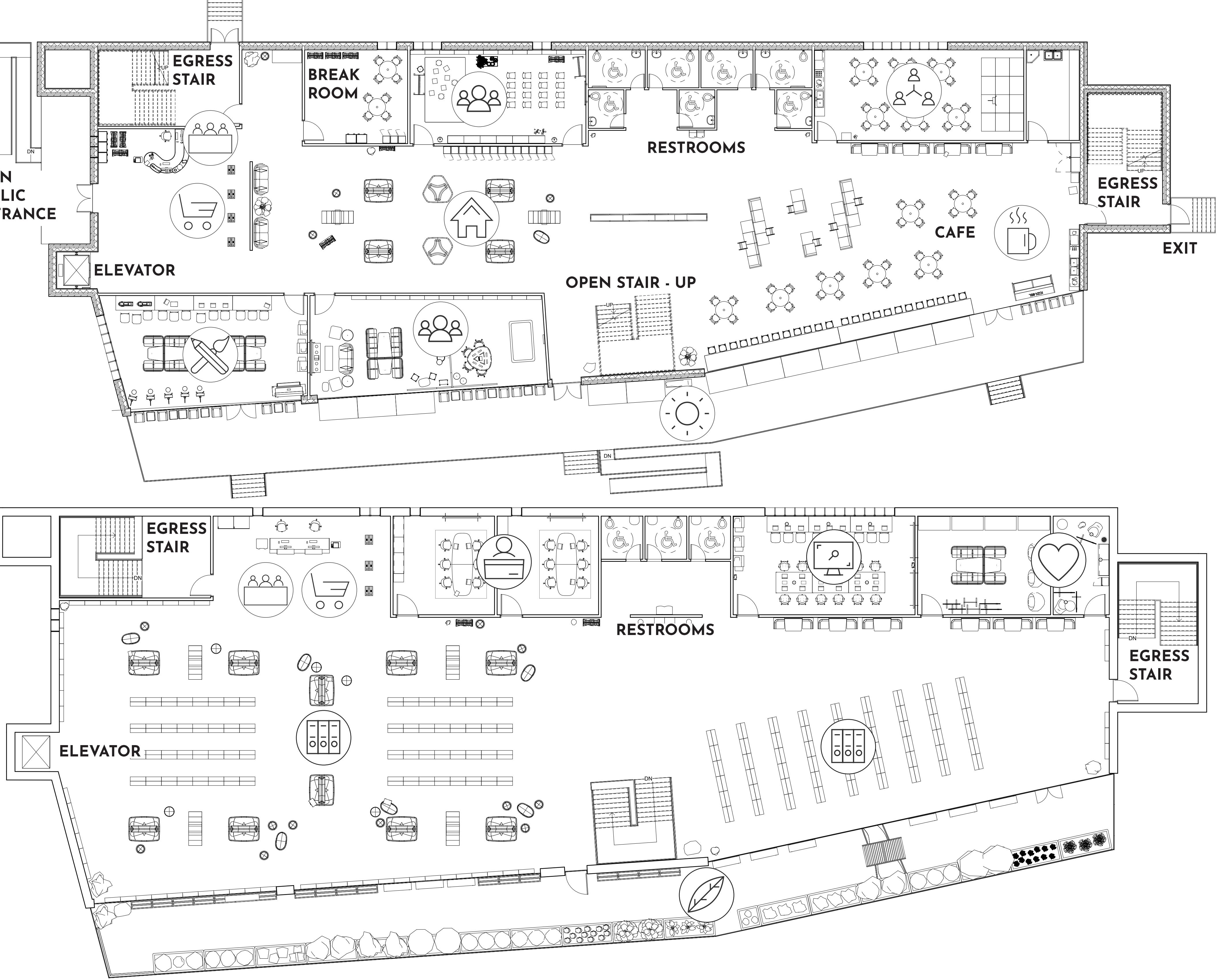

Floor Plan Guide

	Resource Desk - Our two resource desks (one per floor) are staffed with friendly team members ready to help you find books, navigate technology, or answer any questions.
	Self Checkout - Skip the line! Self checkout is available at any of the digital kiosks throughout the library. Digital lending is also available for those with online accounts.
	Makerspace - This creative lab offers 3D printers, sewing machines, painting easels, digital printing, and hands-on tools for every age. This is the space where learning meets doing.
	Teen and Children's Spaces - These spaces are designed for youth and teens to explore, learn, collaborate, and grow. complete with tech, cozy seating, and curated books.
	Living Room Space - A chill space to relax and read some reference material; such as magazines or zines. Local artists are featured in this section as well!
	Patio - Overlooking Lake Superior, the patio is a quiet outdoor spot to relax, read, or sip a warm drink during the summer months.
	Community Room - A flexible gathering space for workshops, events, and community programs. This room can host anything from art classes and music shows to local meetings and gatherings.
	The Cafe - The cafe has a bunch of self service options, both hot and cold. We have sandwiches, soup, coffee, tea, and more! Overflow seating is also provided in the cafe space.
	Stack Area - Shelving holds the library's collection of books, periodicals, and more. These quiet rows are designed with natural light and clear wayfinding for easy browsing.
	Enclosed Garden - This indoor garden is a peaceful, plant-filled sanctuary. It encourages sensory learning and features some plant species that grow locally in Duluth. Closed during the winter!
	Study Rooms - Private and group study rooms are available for reservation. These tech-friendly spaces are ideal for focused work or collaborative study.
	Digital Resource Spaces - Equipped with laptops, high-res monitors, charging stations, and modern seating, these stations are built for research, online learning, and digital creation.
	Wellness Spaces - Peaceful spaces designed to support comfort, sensory needs, and personal care. The connected Mother's Room offers privacy and a mini fridge for milk storage.

Concept & Mood



Concept: Nature & Knowledge

Nature & Knowledge is a design concept that emphasizes on sustainability and lifelong learning.

Spaces will be designed for discovery and a reflection of nature.

The library will also focus on community engagement, community resources, and locally inspired elements.



FF&E & Key Materials



FF&E Selections

- Etta Children's Chair
- Snowsound USA - Napwork Collection
- Snowsound USA - Snowpouf Collection
- Herman Miller - Pullman Booth
- Estey - Library Shelving
- Takeform - Breach Sign. T: Timber Wolf B: No Touchy Black
- Bolta All About Big Geo Wallcovering Collection - Denim
- Mayer Fabrics Continuum - Saffron (Found on Napwork)
- Skyline Design Kids Glass - Animals
- Lonseal Lonwood LVT - Island White (Main Flooring)
- Armstrong Imperial Texture Standard Excelon - Yellow
- Benjamin Moore Paint - Ice Milk